



Tile & Stone  
Installation Systems  
**Product Catalog**

# ABOUT

## OVER 50 YEARS EXPERIENCE

Since 1971, Merkrete has successfully provided over one billion square feet of tile and stone installation systems. Merkrete has become one of the tile market's most respected brands for innovation, technical knowledge and unique products for commercial and residential installations.

## A COMPLETE SOLUTION

Bottom to top, we've got you covered. From underlayment material to grouts, Merkrete products form one of the most complete and diversified tile and stone installation solutions in the industry.

**Surface Preparation:** Merkrete's patching, self-leveling and underlayment products are specifically designed to prepare and repair surfaces to provide an acceptable foundation for the installation of tile and stone.

**Waterproofing and Crack Isolation:** Composed of low-VOC modified elastomeric copolymers, Merkrete's Hydro Guard membranes are 100 percent waterproof and limit the transfer of substrate cracks to the finished tile or stone surface. Merkrete's Fracture Guard products are the most recognized and respected crack isolation membrane solutions in the tile and stone industry today.

**Mortars and Adhesives:** Merkrete's full line of polymer-modified Portland cement mortars and adhesives is formulated for a wide variety of applications such as large and heavy tile, rapid-setting installations and more.

**Grouts:** Merkrete offers several types of grouts, from traditional Portland cement products to 100-percent-solids epoxy. With a vast array of today's colors and innovations such as DUSTLESS and Slake-Free technologies, Merkrete's grout family has emerged as one of the industry's full-line solutions for any type of grouting job.

**Additives:** Merkrete additives are designed to improve the performance of Merkrete products. Merkrete additives offer decreased setting times, stronger bond strengths and enhancing surface treatments.

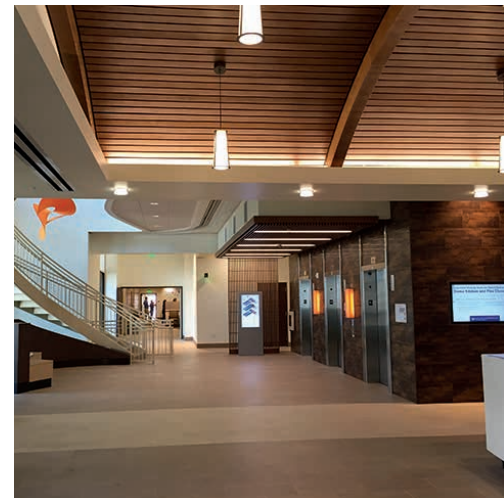

MERKRETE TILE & STONE INSTALLATION SYSTEMS PRODUCT CATALOG  
Table of Contents

---

SURFACE PREPARATION	4-5
CRACK ISOLATION / WATERPROOFING	6-7
SETTING MATERIALS	8-11
GROUT	12-13
PRIMERS	14-15
MAINTENANCE	16
COVERAGE CHARTS	17
GROUT COLOR COLLECTION	18-19
PRODUCT CHARTS	20-21
WARRANTY	22
WEBSITE / SOCIAL MEDIA	23



## SURFACE PREPARATION



### PRO PATCH PLUS

A quick-setting polymer-modified skim coating compound for repairing, finishing and smoothing interior and exterior subfloors.

- Ideal for patching and leveling from featheredge to 1/2"
- Initial set in 1/2 hour
- Embossed floor leveler
- Compatible bond with all floor covering adhesives

Item Code	Product	Size
2528	ME Pro Patch Plus	25-lb. Bag



### PRO PATCH AL1

A fast-setting high-end polymer-modified skim coat compound specifically formulated to smooth and finish substrates before installation of luxury vinyl tiles, resilient sheet goods, vinyl composition tile (VCT), carpet and glued-down installation of floor coverings, ceramic tile and stone.

- Ideal for patching and leveling from featheredge to 1"
- Fast setting
- Ideal for vinyl (VCT), carpet, glued-down floor coverings, ceramic tile, and stone.
- Embossed floor leveler

Item Code	Product	Size
3630	ME Pro Patch AL1	10-lb. Box



### UNDERLAY C

An underlayment that forms an acceptable surface for floor coverings such as vinyl. It is also used to repair concrete surfaces. Underlay C is ideal for achieving a slope base foundation for drainage in areas such as showers, drainage under exterior elastomeric deck coatings, or any floor requiring slope for drainage purposes.

- May be installed from 1/8" to 3"
- Easy to install by screed or trowel for a smooth and uniform finish
- Excellent bond to concrete, wood and metal with minimal preparation
- Cures quickly in 6 – 8 hours

Item Code	Product	Size
1879	ME Underlay C	50-lb. Bag



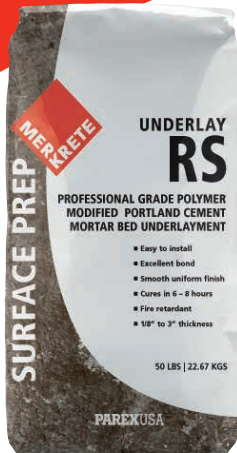

## UNDERLAY RS

A fast-setting, troweled polymer-modified underlayment designed to provide a suitable surface for floor coverings such as vinyl, resilient tile, carpet, ceramic and stone tile. Ideal for achieving a slope base foundation for any floor requiring a slope.

- May be installed from 1/8" to 3"
- Easy to install by screed or trowel for a smooth and uniform finish
- Excellent bond to concrete, wood and metal with minimal preparation
- Cures quickly in 2 – 4 hours

Item Code	Product	Size
1885	ME Underlay RS	50-lb. Bag



## UNDERLAY SLU

A Portland-cement-based pourable, pumpable and free-flowing underlayment for rapid leveling of interior substrates. Underlay SLU is specifically formulated to smooth out and level substrates and provide excellent durability. It is acceptable for the installation of all floor coverings.

- Ideal for leveling from featheredge to 3/4" thickness
- Quick setting
- Easy to use and apply

Item Code	Product	Size
1886	ME Underlay SLU	50-lb. Bag



## SELF LEVELING PRIMER

A uniquely formulated emulsion that must be applied to all substrates before application of Merkrete's Underlay SLU to achieve proper bond.

- Increases bond strength
- Inhibits rapid water loss
- Easy to apply

Item Code	Product	Size
1883	ME Self Leveling Primer	1-gal. Jug

## CRACK ISOLATION



### FRACTURE GUARD **FD**

A low-VOC, fast-drying crack isolation membrane for same-day tile installations. It provides a thin protective layer that inhibits transfer of substrate cracks up to 1/8". Fracture Guard FD conforms to any shape and pattern, allowing endless architectural designs.

- Fast-drying formula
- Isolates cracks up to 1/8"
- Can be applied with a brush, roller or trowel
- Exceeds ANSI A118.12 for crack isolation

Item Code	Product	Size
1779	ME Fracture Guard FD	3.5-gal. Pail



### FRACTURE **GUARD**

The first liquid-applied membrane to provide crack isolation up to 1/8". Fracture Guard offers maximum protection for your tile and stone installations by inhibiting the transfer of cracks from the substrate to the ceramic, porcelain or stone tile. It is ultra-flexible with an elongation over 1,000 percent.

- Adheres to all common surfaces
- Isolates cracks up to 1/8"
- Can be applied with a brush, roller or trowel
- Exceeds ANSI A118.12 for Crack Isolation

Item Code	Product	Size
3139	ME Fracture Guard	3.5-gal. Pail







## HYDRO GUARD SP-1

A fast-drying thin, load-bearing waterproof and crack isolation membrane composed of modified elastomeric copolymers.

- Dries faster than typical waterproofing products
- Water and vapor proof
- Water (flood) test after 4 – 6 hour cure
- Exceeds ANSI A118.10 and A118.12

Item Code	Product	Size
1801	ME Hydro Guard SP1	1-gal. Pail
3793	ME Hydro Guard SP1	3.5-gal. Pail
1807	ME Hydro Guard SP1	5-gal. Pail



## HYDRO GUARD 1

A liquid membrane for use in commercial buildings, residential housing and other areas requiring reliable waterproofing.

- Adheres to all common surfaces
- Water and vapor proof
- Isolates cracks up to 1/8"
- Exceeds ANSI A118.10 and A118.12

Item Code	Product	Size
1802	ME Hydro Guard 1	1-gal. Pail
2591	ME Hydro Guard 1	3.5-gal. Pail



## HYDRO GUARD 2000

A heavy-duty, thin, modified elastomeric copolymer with excellent elongation properties and high strength.

- Dries faster than typical products
- Water and vapor proof
- Isolates cracks up to 1/8"
- Exceeds ANSI A118.10 and A118.12

Item Code	Product	Size
1797	ME Hydro Guard 2000	2 gal.-Pail
1798	ME Hydro Guard 2000	5 gal.-Pail

# SETTING MATERIALS



## 820 DUSTLESS MERLITE

High bond strength in a lightweight formula with excellent handling characteristics for a wide variety of floor and wall tile installations. Merlite is 40 percent lighter than traditional mortars, making it an excellent choice for setting large and heavy tile and stone.

- Non-slump — for use with large and heavy tile and natural stone
- Non-sag and non-slip formula holds wall tiles in place
- Features patented DUSTLESS Technology
- 30 lbs. of lightweight material cover the same area as 50 lbs. of traditional mortar
- Exceeds ANSI A118.4, A118.11 and A118.15



Item Code	Product	Color	Size
4319	ME 820 DLT Merlite	Gray	30-lb. Bag
4320	ME 820 DLT Merlite	White	30-lb. Bag



## 750 RS

A rapid-setting mortar with flexibility and higher strengths for interior and exterior installation of ceramic tile, porcelain tile, and stone on residential and commercial projects.

- For use in time-critical installations
- Allows for grout in as little as 3 hours and light traffic in 4 hours
- Excellent for tile repairs and small applications
- Exceeds ANSI A118.4 and A118.11

Item Code	Product	Color	Size
3312	ME 750 Rapid Set	Gray	25-lb. Bag
3311	ME 750 Rapid Set	White	25-lb. Bag



## 720 RS

A rapid-setting, polymer-modified LHT mortar with exceptional performance and flexibility designed to set large and heavy tile and stone for fast-track commercial or residential installations.

- For use in time-critical installations
- Allows for grout in as little as 3 hours and light traffic in 4 hours
- Excellent for tile repairs and small applications
- Exceeds ANSI A118.4 and A118.11

Item Code	Product	Color	Size
3334	ME 720 Rapid Set	Gray	50-lb. Bag
3333	ME 720 Rapid Set	White	50-lb. Bag







## 855 DUSTLESS XXL

A polymer-modified Portland cement mortar for installing extra large and heavy porcelain, ceramic tile and natural stone on alls and floors.

- High bond strength and initial grab
- Non-sag and non-slip formula holds wall tiles in place
- Non-slump — for use with large and heavy tile and natural stone
- Features patented DUSTLESS Technology
- Exceeds ANSI A118.4, A118.11 and A118.15



Item Code	Product	Color	Size
4321	ME 855 DLT XXL	Gray	50-lb. Bag
4322	ME 855 DLT XXL	White	50-lb. Bag



## 735 DUSTLESS PREMIUM FLEX

A superior-grade, polymer-modified flexible thin set mortar offering higher strength and extended adjustability and open times.

- High flexibility to prevent cracks in tile
- Excellent bond strengths
- Features patented DUSTLESS Technology
- Exceeds ANSI A118.4 and A118.11



Item Code	Product	Color	Size
4317	ME 735 DLT Premium Flex	Gray	50-lb. Bag
4318	ME 735 DLT Premium Flex	White	50-lb. Bag



## 725 DUSTLESS PREMIUM LHT MORTAR

A premium polymer-modified Portland cement mortar for installing large and heavy porcelain, ceramic tile and natural stone on both walls and floors.

- Non-slumping and high bond strength
- For use with large and heavy tile and natural stone
- Features patented DUSTLESS Technology
- Exceeds ANSI A118.4 and A118.11



Item Code	Product	Color	Size
4307	ME 720 DLT Premium LHT	Gray	50-lb. Bag
4308	ME 720 DLT Premium LHT	White	50-lb. Bag



## 720 DUSTLESS PREMIUM LHT MORTAR

A polymer-modified Portland cement mortar for installing large and heavy porcelain, ceramic tile and natural stone on both walls and floors.

- Non-slumping and high bond strength
- For use with large and heavy tile and natural stone
- Features patented DUSTLESS Technology
- Exceeds ANSI A118.4 and A118.11



Item Code	Product	Color	Size
4305	ME 720 DUSTLESS LHT	Gray	50-lb. Bag
4306	ME 720 DUSTLESS LHT	White	50-lb. Bag

# SETTING MATERIALS



## 710 DUSTLESS PREMIUM SET PLUS



A professional-grade thin set mortar designed for interior and exterior floor and wall installations of all types of ceramic tile, porcelain tile and stone over concrete, exterior-glue plywood and a variety of substrates.

- Higher bond strengths for tile and stone installations
- Bonds to cement and exterior-grade plywood surfaces
- Features patented DUSTLESS Technology
- Exceeds ANSI A118.4 and A118.11

Item Code	Product	Color	Size
4303	ME 710 DLT Premium Set	Gray	50-lb. Bag
4304	ME 710 DLT Premium Set	White	50-lb. Bag



## 705 DUSTLESS PRO SET PLUS



A professional-grade thin set mortar for installing porcelain, ceramic tile and stone to walls and floors in commercial and residential applications.

- For standard tile and stone installations
- Bonds to cement and exterior-grade plywood surfaces
- Features patented DUSTLESS Technology
- Exceeds ANSI A118.4 and A118.11

Item Code	Product	Color	Size
4301	ME 705 Pro Set Plus DLT	Gray	50-lb. Bag
4302	ME 705 Pro Set Plus DLT	White	50-lb. Bag



## 703 THIN SET

A professional-grade, polymer-modified thin set mortar that delivers good bond strengths for basic tile and natural stone installations over most common types of surfaces.

- For basic installations
- Bonds to cement and exterior-grade plywood surfaces
- Exceeds ANSI A118.4 and A118.11

Item Code	Product	Color	Size
3087	ME 703 Thin Set	Gray	50-lb. Bag
3088	ME 703 Thin Set	White	50-lb. Bag

*\*Available East and Central Regions Only*



# SETTING MATERIALS



## PRO MASTIC 400

A professional formula adhesive with great bond strength. It is ideal for small-format tile with intermittent water exposure.

- For standard wall, floor and countertop installations
- Smooth; easy to trowel
- Exceeds ANSI A136.1 Type 1 requirements for intermittent water exposure

Item Code	Product	Size
3798	ME PRO MASTIC 400 1 GAL	1-gal. Pail
3799	ME PRO MASTIC 400 3.5GAL	3.5-gal. Pail



## 136 SURESTIK

A ready-to-use, acrylic-based, non-sag, quick-grab, type 1 adhesive for installing tile, stone and mosaic tile on interior walls.

- Economical and ready-to-use formula
- Non-sag
- Excellent workability

Item Code	Product	Size
1870	ME 136 Surestik	1-gal. Pail
1871	ME 136 Surestik	3.5-gal. Pail



## 700 PREMIUM SET

A standard-grade, non-modified thin set mortar for installing ceramic and stone tile on walls and floors.

- For basic installations
- Exceeds ANSI A118.1

Item Code	Product	Color	Size
1698	ME 700 Premium Set	Gray	50-lb. Bag
1699	ME 700 Premium Set	White	50-lb. Bag



## 210/211 SYSTEM

200 Krete Latex and 211 Krete Filler powder is a two-component, superior-grade polymer-modified Portland cement flexible thin set mortar for installing ceramic tile and natural stone.

- Excellent adhesion properties
- Water, shock and weather resistance
- For demanding exterior facade installations
- Exceeds ANSI A118.4

Item Code	Product	Color	Size
1774	ME 211 Krete Filler	Gray	50-lb. Bag
1775	ME 211 Krete Filler	White	50-lb. Bag
1697	ME 200 Krete Latex		5-gal. Jug



# GROUT

## ELITE READY-TO-USE GROUT



Item Code	Product	Colors	Size
3772-XXXXX	ME Elite RTU	14*	1-gal. Pail

\*See Grout Color Chart pp. 18-19

ELITE RTU Grout is a professional-grade, ready-to-use specialty grout for precision commercial and residential installations of porcelain, ceramic and natural-stone tiles. It is formulated with the latest innovation in colored quartz aggregate, which ensures color consistency, ease of cleanability and improved workability.

- Stain- and chemical-resistant grout formulation with no sealing required
- Dries to a hard, uniform color surface in 24 hours
- Will not stain surfaces
- Crack-resistant and shrinkage-controlled formulation, with no efflorescence
- Used straight from the pail, without the need to add water

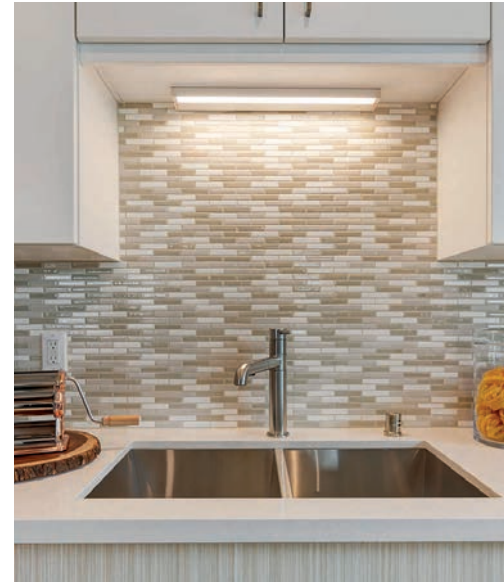

## DURACOLOR

A professional-grade polymer-modified Portland cement sanded grout specifically formulated for grouting all types

of ceramic and dimensional stone tiles. It is suitable for walls and floors in residential and commercial applications.

- Available in sanded and non-sanded
- Polymer fortified for hard, durable, professional results
- Stain resistant and color consistent
- Sanded: For 1/8" to 1/2" grout joints
- Non-sanded: For grout joints up to 1/8"
- Exceeds ANSI A118.6

Item Code	Product	Colors	Size
3667-XXXXX	ME Duracolor Sanded Grout	31*	25-lb. Bag
3670-XXXXX			10-lb. Box
3668-XXXXX	ME Duracolor Non-Sanded Grout	31*	10-lb. Box
3669-00010	ME Dry White Grout	White	25-lb. Bag

\*See Grout Color Chart pp. 18-19



## PROGROUT PLUS

A premium-grade latex-based Portland cementitious high-performance grout, uniquely formulated for grouting the vast range of ceramic, porcelain, and natural stone tile types set in various environmental conditions.

- Color consistent
- Stain resistant and efflorescence free
- For grout joints from 1/16" to 1/2" wide
- Exceeds ANSI A118.7

Item Code	Product	Colors	Size
2573-XXXXX	ME Progrout Plus	18*	25-lb. Bag

\*See Grout Color Chart pp. 18-19





## PRO EPOXY

A three-component system containing a resin and hardener that are combined with colored sand to fill joint widths from 1/8" to 3/8". Pro Epoxy offers maximum stain resistance and color consistency.

- Chemical and stain resistant
- Color consistent
- Easy to apply and cleans up easily with water
- Exceeds ANSI A118.3

Item Code	Product	Colors	Size
1841-XXXXX	ME Pro Epoxy Commercial Kit	20*	2-gal. Pail
1842	ME Pro Epoxy Parts A & B		1-gal. Pail
1843-XXXXX	ME Pro Epoxy Part C (Colored Sand)	20*	11-lb. Box

\*See Grout Color Chart pp. 18-19



## INTEGRA

An all-in-one thin set and grout, Integra is ideal for installing mosaics and glass tile on walls and floors without causing thinset "bleed through."

- Non-abrasive all-in-one thin set and grout
- Color consistent – thin set and grout are the same color
- Specifically designed for glass and mosaic tiles on floors and walls
- Exceeds ANSI A118.4 and A118.6

Item Code	Product	Colors	Size
1815-XXXXX	ME Integra	8*	25-lb. Bag

\*See Grout Color Chart pp. 18-19



## COLORED CAULKING

An exceptional, one-part siliconized acrylic-based caulking compound that is mold and mildew resistant. Available in both sanded and smooth (non-sanded) formulations for all Merkrete Grout colors.

- Maximum joint width and depth should not exceed 1/4"
- Designed for use around tubs and sinks with sanded grout
- Use where horizontal and vertical surfaces meet

Item Code	Product	Colors	Size
1748-XXXXX	ME Color Caulk Sanded	31*	10.3-oz. Tube
1749-XXXXX	ME Color Caulk Smooth	31*	10.3-oz. Tube

\*See Grout Color Chart pp. 18-19



## MK 100% SILICONE CAULK

A high-performance, commercial-grade 100-percent-silicone caulk that is developed for use in coves, corners and changes in plane with interior, exterior or submerged applications.

- For interior and exterior use with tile or stone
- Flexible material for use in expansion joints
- Suitable for wet and submerged areas
- ASTM C920 / C794

Item Code	Product	Colors	Size
1785-XXXXX	ME 100% Silicone Caulk	18* + clear	10.3-oz. Tube

\*See Grout Color Chart pp. 18-19

## PRIMERS



## 101 OVERSPRAY PRIMER

A primer and bonding agent used before installing Merkrete's waterproof and crack isolation membranes under ceramic, tile and stone.

- Reduces porosity factor
- Increases bond on most of substrates

Item Code	Product	Size
1836	ME 101 Overspray Primer	2-gal. Pail
1837	ME 101 Overspray Primer	5-gal. Pail



## UNDERLAY SLU PRIMER

A uniquely formulated emulsion that must be applied to all substrates before pouring Merkrete's Underlay SLU to achieve proper bond.

- Increases bond strength
- Inhibits rapid water loss
- Easy to apply

Item Code	Product	Size
1883	ME Underlay SLU Primer	1-gal. Jug







## BURST

Burst Add-A-Pak is a powerful additive used to give Portland cement products a burst of accelerant for faster set times. It is used to help speed up work times in most Portland cement products such as mud beds, masonry mortars, underlayments, thin sets and grouts.

- Easy-to-use, powerful additive that accelerates set time
- Does not affect grout performance characteristics
- Excellent for repair work

Item Code	Product	Size
2521	ME Burst Accelerator	1-lb. Bag



## 150 LATEX

A compounded and stabilized latex additive that improves bond strength, water resistance, compressive strength and other physical properties of cement/sand mixes and grouts.

- Improves adhesion to both old and new surfaces
- Reduces cracking of grout joints
- Resists water infiltration

Item Code	Product	Size
1694	ME 150 Latex	1-gal. Jug
1696	ME 150 Latex	5-gal. Jug



## MERKRETE FABRICS

Merkrete's reinforcing fabrics are strong, absorbent polyester reinforcing materials for use with Hydro Guard waterproofing membranes.

Item Code	Product	Size
1761	Fabric Type 2 (1300 sq. ft.) Kit	1 Roll 36" x 405' + 1 Roll 8" x 165'
1762	Fabric Type 2 (280 sq. ft.) Kit	1 Roll 36" x 75' + 1 Roll 8" x 90'
1766	Fabric Type 2 (Base Roll)	1 Roll 36" x 405'
1769	Fabric Type 2 (Base Roll)	1 Roll 8" x 165'
1770	Fabric Type 2 (Base Roll)	1 Roll 8" x 90'
1771	Burlap Type 3 (10")	1 Roll 300 linear ft.
1772	Burlap Type 3 (40")	1 Roll 1000 linear ft.

# MAINTENANCE



## REVIVE

A pigmented water-based urethane acrylic grout stain and sealer designed to revive grout.

- Water-based urethane acrylic grout stain and sealer
- For revitalizing or changing color of older sanded and non-sanded grouts
- Designed to help protect against moisture and staining

Item Code	Product	Colors	Size
1862-XXXXX	ME Revive	30	8-oz. Bottle
*See Grout Color Chart pp. 18-19			



## GROUT SEALER



A penetrating silicone sealer for new or old Portland cement grout. It is a water-based, silicone resin designed to protect grout surfaces from stains and water.

- Suitable for porous, absorbent masonry, clay, stone, marble and Portland cement grouts
- Protects grout surfaces from stains and water
- Quick penetration
- Maintains a natural look

Item Code	Product	Size
1794	ME Grout Sealer	1-gal. Jug
1795	ME Grout Sealer	1-qt. Jug



# GROUT SOLUTIONS

## Coverage Charts

### PROGROUT PLUS / INTEGRA / DURACOLOR

Per 25-lb. Bag

NOMINAL TILE SIZE	JOINT WIDTH			
	1/8"	1/4"	3/8"	1/2"
2" x 2" x 1/4"	93	48	33	26
4" x 4" x 3/8"	122	62	42	32
4" x 8" x 3/8"	162	82	55	42
6" x 6" x 3/8"	182	92	62	47
6" x 8" x 3/8"	208	105	70	53
8" x 8" x 3/8"	242	122	82	62
10" x 10" x 3/8"	302	152	102	77
12" x 12" x 3/8"	362	182	122	92
15" x 15" x 3/8"	452	227	152	114
16" x 16" x 3/8"	482	242	162	122
18" x 18" x 3/8"	542	272	182	137
20" x 20" x 3/8"	602	302	202	152

### DURACOLOR Non-Sanded

Per 10-lb. Box

NOMINAL TILE SIZE	JOINT WIDTH		
	1/16"	3/32"	1/8"
1" x 1" x 1/4"	53	36	27
2" x 2" x 1/4"	103	69	53
4" x 2" x 1/4"	137	92	69
4" x 4" x 3/8"	137	92	69
4" x 8" x 3/8"	182	122	91
6" x 6" x 3/8"	205	137	103
8" x 8" x 3/8"	272	182	137
8" x 10" x 1/2"	227	152	114
10" x 10" x 3/8"	340	227	171
12" x 12" x 3/8"	408	272	205
15" x 15" x 3/8"	510	340	256

### PRO EPOXY

Per 1-Gallon Unit

NOMINAL TILE SIZE	JOINT WIDTH		
	1/8"	1/4"	3/8"
4" x 8" x 1/2"	72	36	26
6" x 6" x 3/8"	106	58	40
6" x 6" x 1/2"	80	42	28
8" x 8" x 3/8"	142	72	58
12" x 12" x 3/8"	210	106	72
12" x 12" x 1/2"	156	80	54
12" x 12" x 5/16"	84	42	28
13" x 13" x 3/8"	228	116	78
16" x 16" x 3/8"	280	142	96
18" x 18" x 3/8"	312	156	106
20" x 20" x 3/8"	344	176	118

### ELITE READY-TO-USE GROUT

Per 1-Gallon Unit

NOMINAL TILE SIZE	JOINT WIDTH					
	1/16"	1/8"	3/16"	1/4"	3/8"	1/2"
2" x 2" x 1/4"	103	50	33	24	15	11
4-1/4" x 4-1/4" x 1/4"	221	109	72	54	35	26
6" x 6" x 1/4"	313	155	103	77	50	37
8" x 8" x 3/8"	278	138	91	68	45	33
12" x 12" x 3/8"	417	208	138	103	68	50
24" x 6" x 3/8"	334	166	110	82	54	40
24" x 12" x 3/8"	557	278	184	138	91	68

Coverages are approximate and may be reduced based on project conditions, actual tile size, waste and other factors. Please reference Merkrete's Grout Calculator for other tile sizes and more details.



## GROUT COLOR CHART

## GROUT COLOR

Tile size, style, color, composition and areas of use constantly evolve. So must the tile installation products. Using the correct installation products is vital to the success of every tile project and selecting the right grout is just as important.

## GROUT COLORS

All colors available in Duracolor Sanded and Non-Sanded, Colored Caulking, and Revive.

**PG** ProGrout **PE** Pro Epoxy **I** Integra **SC** 100% Silicone Caulk **U** Ultima **E** Elite RTU

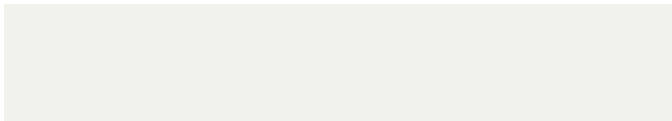
00010 BRIGHT WHITE **PGP I SC**00011 SNOW WHITE **PGP I SC E**00012 NAVAJO WHITE **PGP PE SC E**00015 SWISS COFFEE **I**00017 BONE **PE I**00018 CREAM **PGP PE SC E**00021 CANVAS **PGP PE SC E**

00023 LATTE

00024 CHAMOIS **PE**00025 TUMBLEWEED **PGP PE I SC E**00030 SILVER **PGP PE I SC E**00032 LIGHT TAUPE **PGP PE SC**00034 RIVER ROCK **PGP PE SC E**00035 NATURAL GRAY **PGP PE SC E**00038 GRAY **PGP PE I SC E**

00057 HARVEST

## GROUT COLOR CHART

## COLLECTION



00063 CARMEL PE



00134 NEW ADOBE



00137 AZTEC



00162 TRUE TAUPE PGP PE SC

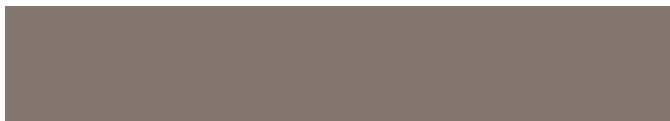

00175 DARK CHOCOLATE PGP SC E



00178 COCO PE



00525 BLACK SAPPHIRE PGP PE I SC E



00572 NEW DENIM



00583 ANCIENT JADE



00071 SANDSTONE PGP PE SC E



00145 MOCHA PE



00147 ESPRESSO

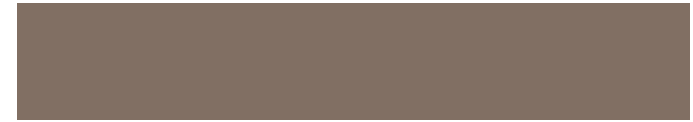

00150 SANTA FE PGP PE SC E



00153 BUCKSKIN PGP PE I SC E



00191 TERRACOTTA PGP SC PE



Sample colors shown are approximate to the final grout color. Final installed grout color may vary due to job conditions, tile porosity, mixing ratio, sealers, installation methods, temperature, or individual batches. Use grouts with the same batch number whenever possible. Different batch numbers should be dry blended together to obtain color uniformity. Follow ANSI A108.10 grouting practices. Please contact Customer Care Department for further questions at 877-547-8822.

# PROJECT GUIDE

Product	Main Feature	ANSI			Substrate								Application Area			
		A108.1B	A118.10	A118.12	Concrete or Masonry	Cementitious Backer Units	Masonry Block with Mortar Joints (CMU)	Gypsum Wall Board and Underlayments (i.e) Maxxon	Exterior Grade Plywood (EGP)	Existing Tile, Marble and Terazzo	Existing Vinyl	Cutback Adhesive	Interior		Exterior	
												Floors	Walls	Floors	Walls	

### Surface Preparation

ProPatch Plus	Feather edge to 3/4"	●			●	○	○	○	●		○	○	●	●	●	●
ProPatch AL1	Feather edge to 1"	●			●	●	●	●	●	●	●		●		●	
Underlay C	1/4" to 3" thickness	●			○	○	○	○	○	○	○	○	●			
Underlay RS	Rapid Set	●			○	○	○	○	○	○	○	○	●			
Underlay SLU	Self Leveling	●			○	○			○	○	○	○	●			

### Waterproofing and Crack Isolation

Hydro Guard 1	Waterproofing and crack isolation up to 1/8"		●	●	○	○	○	○	○	○	○	○	○	●	●	●	○
Hydro Guard 2000	Heavy-duty waterproofing and crack isolation up to 1/8"		●	●	●	●	●	●	●	●	●	●	●	●	●	●	●
Hydro Guard SP1	Fast-drying waterproofing and crack isolation up to 1/8"		●	●	●	●	●	●	●	●	●	●	●	●	●	●	●
Fracture Guard	Crack isolation up to 1/8"			●	○	○	○	○	○	○	○	○	○	●	●	●	●
Fracture Guard FD	Fast-drying crack isolation up to 1/8"			●	○	○	○	○	○	○	○	○	○	●	●	●	●

○ Good   ○ Better   ● Best

#### Suitable Substrates For Merkrete Adhesives

- Brick Masonry
- Cement Backer Board
- Cement Mortar Beds
- Cement Plaster
- Ceramic Tile and Stone
- Concrete Masonry
- Exterior-Grade Plywood
- Gypsum Wallboard
- Merkrete Waterproofing
- Merkrete Crack Isolation

For further information, please contact our technical department at (800) 226-2424 or visit our website for specific product information: [www.merkrete.com](http://www.merkrete.com)



# SELECTOR

Product	Main Feature	ANSI						Type					Application Area				
		A118.3	A118.6	A118.4	A118.11	A118.15	A136.1	Ceramic	Porcelain	Glass Tile	Marble and Terazzo	Stone	Green Marble	Interior		Exterior	
														Floors	Walls	Floors	Walls
<b>Adhesives</b>																	
700	Professional Grade			●				●				○		●	●	●	●
703	Multipurpose			●	●			●	○			○		●	●	●	●
705 DLT	Multipurpose			●	●			●	○			○		●	●	●	●
710 DLT	Multipurpose			●	●			●	◐	○	◐	◐		●	●	●	●
720 DLT	LHT Mortar			●	●			●	◐	○	◐	◐		●	●	●	●
720 RS	Rapid-Setting LHT Mortar			●	●			●	◐	○	◐	◐		●		●	
725 DLT	LHT Mortar			●	●			●	●	◐	●	●		●	●	●	●
735 DLT	Flexible			●	●	●		●	●	◐	◐	◐		●	●	●	●
750 RS	Rapid Setting			●	●			●	◐	○	◐	◐		●	●	●	●
820 DLT	Lightweight			●	●	●		●	●		○	○		●	●	●	●
855 DLT	Large Format Tiles			●	●	●		●	●		●	●		●	●	●	●
Pro Epoxy	100% Epoxy Adhesive and Grout	●		●	●	●		●	●	●	●	●	●	●	●	●	●
Integra	All-in-one Adhesive and Grout	●	●	●	●					●				●	●	●	●
Pro Mastic 400	Type 1 Tile Adhesive						●	●	●	●					●		
136 Surestik	Ready-to-Use Type 1 Paste Mastic						●	●	●	●					●		
<b>Grouts</b>																	
ProGrout Plus	Color Consistent		●					●	●	●	●	●		●	●	●	●
Pro Epoxy	100% Epoxy Thin-set and Grout	●						●	●	●	●	●	●	●	●	●	●
Duracolor Sanded	Universal Grout for 1/16" to 1/2" joint widths		●					◐	◐	◐	◐	◐		●	●	●	●
Duracolor Non Sanded	For Grout Joint widths 1/8" or less		●					◐	◐	◐	◐	◐		●	●	●	●
Integra	All-in-One Thin-set and Grout		●	●	●			◐	◐	◐	◐	◐		●	●	●	●
Elite	Color Consistent Ready-to-Use Grout							●	●	●	●	●		●	●	●	●

# WARRANTY

## WARRANTY

Merkrete provides product and system warranties that guarantee your installation for up to a lifetime. Our comprehensive warranties provide the peace of mind that professionals and end-users trust and deserve.

## CUSTOMER SATISFACTION

Behind every Merkrete product is revolutionary research, groundbreaking development and unsurpassed commitment to quality, customer service, technical assistance and green innovations.

## INNOVATION

Merkrete, a division of ParexGroup, is a global company that is highly invested in Research and Development. Throughout several R&D facilities worldwide, key employees are involved in the development of new technologies and product innovations, providing our customers with state-of-the-art installation solutions throughout the building products industry. Additional efforts focus on green initiatives and environmentally sustainable solutions. Continuously on the cutting edge of innovation, Merkrete has produced such innovations as:

- DLT – Dustless Technology - produces significantly less dust than ordinary thin sets to improve indoor air quality, promote cleaner working conditions and reduce mess.
- Mold Shield technology protects select Merkrete products from mold and mildew.
- Slake-Free technology ensures mortars and grouts are ready to use after a single mix for substantial time savings.
- Rapid-Setting technology offers early strength, excellent workability, fast curing, and excellent durability to Merkrete's fast-setting line of products.

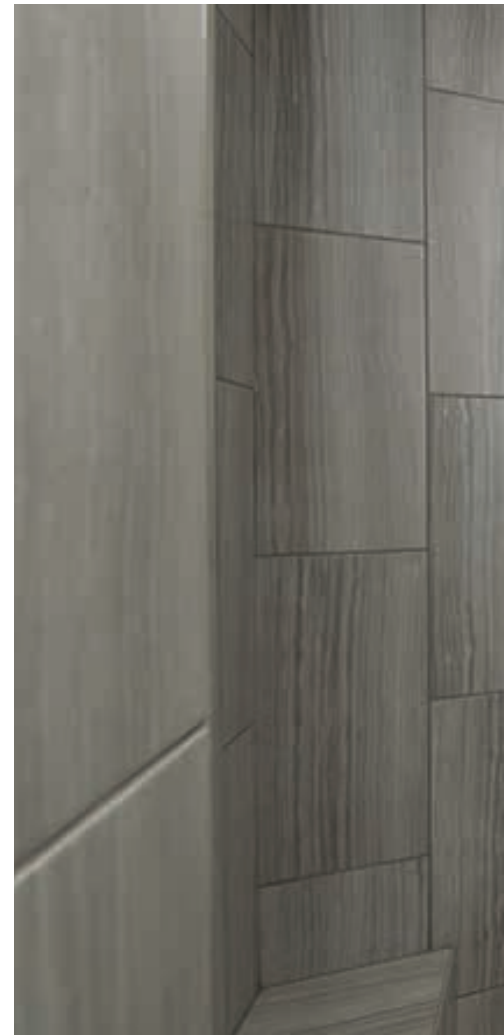



*Through high-touch, personal service, Merkrete offers builders and contractors trusted solutions and expertise across a full line of innovative tile and stone installation systems. From liquid waterproofing membranes to fast-drying products and dustless dry mixes, trust Merkrete to have what you need to get the job done.*

Visit us on the web:



[www.merkrete.com](http://www.merkrete.com)

Connect with us on social media:







**PAREXUSA**

Parex USA Inc., A California  
Company  
2150 Eastridge Ave.  
Riverside, CA 92507  
www.parexusa.com  
886-516-0061  
Tech Support: 800-226-2424